

SIMPLE GENERAL

(door height up to 4,0 m)

motor
position:
LEFT
RIGHT

1,0m

motor
position:
MIDDLE

1,2m

1,4m

1,6m

1,8m

2,0m

MAXIMUM DOOR WIDTH

Infrared Remote
Control

Remote
Control

switches ON-OFF / HI-LOW

- Energy Saving
- Barrier to Insects, Dust Odours, Pollutants & Humidity
- Controlled Microclimate
- Slim Line Design
- Easy Installation
- Conventional or Infrared Remote Control
- Motor position: Center, Left, Right

OPTIONAL

- Filter
- Vertical mount
- Door switch
- Inox body (430 stainless steel)
- Inox louver (430 stainless steel)

left or right side motor

FOR USE IN:

DEPARTMENTS STORES, LARGE HOTELS, LARGE FAST FOODS,
LARGE SUPER MARKETS, COLD STORAGE PLANTS, AIRPORTS,
BUSS STATIONS & in general LARGE, CROWED & FREQUENTLY VISITED PLACES



cross flow fan
Ø 120 diameter



OPERATION WAYS

- ON-OFF / HI-LOW
with wired remote control (*C.B*)
- ON-OFF / HI-LOW
with infrared remote control (*I.R*)
- ON-OFF / HI-LOW
with wired + infrared
remote control (*R.C*)
- New logic control system (*NL*)
- New eco control system (*ECO*)



TECHNICAL DETAILS

TYPE	L or R-33w	K-34w	K-35w	K-36w	K-37w	K-38w
Max door width (m)	1.0	1.2	1.4	1.6	1.8	2.0
Max door height (m)	4.0	4.0	4.0	4.0	4.0	4.0
Max Outlet velocity (m/sec)	13.0 / 11.0	13.0 / 11.0	13.0 / 11.0	13.0 / 11.0	13.0 / 11.0	13.0 / 11.0
Max Air volume (m ³ /h)	2510 / 2125	2800 / 2370	3370 / 2850	3930 / 3330	4500 / 3800	5065 / 4285
Motor power input (W)	350	350	660	660	660	660
Capacitor (μF)	8	8	12	12	12	12
Noise level in 1 m [dB(A)]	63 / 62	66 / 64	66 / 64	66 / 64	67 / 64	67 / 64
DIMENSIONS	L: Total length (mm)	1149	1242	1442	1642	1842
	W: Total width (mm)	212	212	212	212	212
	H: Height (mm)	205	205	205	205	205
	I: Outlet length (mm)	900	1199	1400	1601	1802
	w: Outlet width (mm)	76	76	76	76	76
	h: Outlet height (mm)	64	64	64	64	64
Weight (kg)	19	22	24	26	28	30
Power supply (V/Hz/N-)	230 / 50 / 1	230 / 50 / 1	230 / 50 / 1	230 / 50 / 1	230 / 50 / 1	230 / 50 / 1
Motor speed (rpm)	1370 / 1050	1370 / 1050	1370 / 1050	1370 / 1050	1370 / 1050	1370 / 1050
Ingress Protection	IP20	IP20	IP20	IP20	IP20	IP20

*Company OLEFINI reserves the right to alter given product specifications without further notice.

ELECTRICALLY HEATED GENERAL

(door height up to 3,5 m)



Remote Control



Infrared Remote Control



motor position:
LEFT
RIGHT

1,0m

1,6m

1,8m

motor position:
MIDDLE

1,2m

1,4m

1,6m

1,8m

2,0m

MAXIMUM DOOR WIDTH

- Energy Saving
- Barrier to Insects, Dust Odours, Pollutants & Humidity
- Slim Line Design
- Easy Installation
- Low Noise Level
- 9, 12, 15 or 18 kW heating load (depending on models size)
- Motor position: Center, Left, Right

tubular heating elements



power supply connection



top view

TECHNICAL DETAILS

TYPE	L or REH-33w	KEH-34w	KEH-35w	L or REH-36w	KEH-36w	L or REH-37w	KEH-37w	KEH-38w
Max door width (m)	1.0	1.2	1.4	1.6	1.6	1.8	1.8	2.0
Max door height (m)	3.5	3.5	3.5	3.5	3.5	3.5	3.5	3.5
Max Outlet velocity (m/sec)	12.0 / 10.0	12.0 / 10.0	12.0 / 10.0	12.0 / 10.0	12.0 / 10.0	12.0 / 10.0	12.0 / 10.0	12.0 / 10.0
Max Air volume (m³/h)	2320 / 1930	2590 / 2160	3110 / 2600	4150 / 3460	3630 / 3024	4665 / 3895	4150 / 3460	4675 / 3895
Motor power input (W)	350	350	660	660	660	660	660	660
Capacitor (µF)	8	8	12	12	12	12	12	12
Noise level in 1 m [dB(A)]	62 / 60	65 / 62	65 / 62	65 / 62	65 / 62	65 / 62	66 / 62	66 / 60
L: Total length (mm)	1149	1242	1442	1852	1642	2053	1842	2042
W: Total width (mm)	277	277	277	277	277	277	277	277
H: Height (mm)	205	205	205	205	205	205	205	205
I: Outlet length (mm)	900	1199	1400	1601	1601	1802	1802	2003
w: Outlet width (mm)	76	76	76	76	76	76	76	76
h: Outlet height (mm)	64	64	64	64	64	64	64	64
Weight (kg)	28	31	34	39	37	43	39	41
Thermal power (kW)	9 / 12	12 / 15	12 / 15	12 / 15	12 / 15	15 / 18	15 / 18	15 / 18
Max current cons. (A) (per phase)	13 / 18	18 / 22	18 / 22	18 / 22	18 / 22	22 / 27	22 / 27	22 / 27
T outlet - T inlet (°C)	18-20 / 20-24	16-18 / 18-20	15-17 / 17-19	14-16 / 16-18	14-16 / 16-18	15-17 / 17-19	15-17 / 19-22	14-16 / 17-20
Power supply (V/Hz/N-)	400 / 50 / 3	400 / 50 / 3	400 / 50 / 3	400 / 50 / 3	400 / 50 / 3	400 / 50 / 3	400 / 50 / 3	400 / 50 / 3
Motor speed (rpm)	1380 / 1150	1380 / 1150	1380 / 1150	1380 / 1150	1380 / 1150	1380 / 1150	1380 / 1150	1380 / 1150
Heating stages	4	4	4	4	4	4	4	4
Ingress Protection	IP20	IP20	IP20	IP20	IP20	IP20	IP20	IP20

OPTIONAL

- Filter
- Vertical mount
- Door switch
- Room thermostat
- Inox body (430 stainless steel)

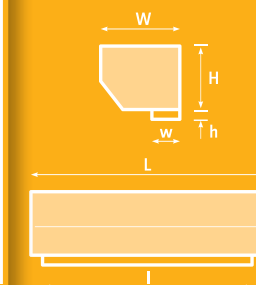

HOT WATER HEATED GENERAL

(door height up to 3,5 m)



heat exchanger

Infrared
Remote
Control



Remote Control



TECHNICAL DETAILS

TYPE	L or RWH-33w	KWH-34w	KWH-35w	KWH-36w	KWH-37w	KWH-38w	
Max door width (m)	1.0	1.2	1.4	1.6	1.8	2.0	
Max door height (m)	3.5	3.5	3.5	3.5	3.5	3.5	
Max Outlet velocity (m/sec)	9.0 / 7.5	9.0 / 7.5	9.0 / 7.5	9.0 / 7.5	9.0 / 7.5	9.0 / 7.5	
Max Air volume (m3/h)	1740 / 1450	1950 / 1625	2340 / 1950	2730 / 2275	3125 / 2600	3515 / 2930	
Motor power input (W)	350	350	660	660	660	660	
Capacitor (µF)	8	8	12	12	12	12	
Capacity (lt)	0.8	0.8	1.0	1.2	1.4	1.6	
Noise level in 1 m [dB(A)]	65 / 62	65 / 62	65 / 62	65 / 62	65 / 62	65 / 62	
DIMENSIONS	L: Total length (mm)	1149	1242	1442	1642	1842	2042
	W: Total width (mm)	277	277	277	277	277	277
	H: Height (mm)	205	205	205	205	205	205
	l: Outlet length (mm)	900	1199	1400	1601	1802	2003
	w: Outlet width (mm)	76	76	76	76	76	76
	h: Outlet height (mm)	64	64	64	64	64	64
	Weight without water (kgr)	26	30	32	35	37	39
*Air Inlet Temperature +15°C		*Water Inlet Temperature +70°C		Flow rate 0.6 (lt/sec) [0.3 lt/sec for R,L]			
Heating power (kW)	12.5 / 11.3	14.1 / 12.8	17.0 / 15.4	20.0 / 17.9	22.4 / 20.3	25.1 / 22.8	
Air outlet temperature (°C)	35.8 / 37.7	36.1 / 37.9	36.1 / 37.9	36.1 / 37.9	35.9 / 37.7	35.7 / 37.6	
Water outlet temperature (°C)	59.9 / 60.8	64.3 / 64.8	63.1 / 63.8	60.7 / 62.7	60.9 / 61.7	59.8 / 60.8	
Pressure drop (water) ΔP (kPa)	3.6	2.9	3.1	3.3	3.4	3.6	
*Air Inlet Temperature +15°C		*Water Inlet Temperature +90°C		Flow rate 0.6 (lt/sec) [0.3 lt/sec for R,L]			
Heating power (kW)	17.2 / 15.6	19.5 / 17.7	23.4 / 21.2	28.0 / 24.6	30.9 / 28.0	34.6 / 31.4	
Air outlet temperature (°C)	43.7 / 46.3	44.1 / 46.6	44.1 / 46.6	39.8 / 46.5	43.8 / 46.3	43.6 / 46.1	
Water outlet temperature (°C)	75.9 / 77.2	82.0 / 82.8	80.4 / 81.3	77.0 / 79.9	77.3 / 78.5	75.9 / 77.2	
Pressure drop (water) ΔP (kPa)	3.5	2.8	2.9	3.1	3.3	3.5	

- Energy Saving
- Barrier to Insects, Dust Odours, Pollutants & Humidity
- Slim Line Design
- Easy Installation
- Low Noise Level
- Water valve connections
- 3/4" water supply connection
- Motor position: Center, Left, Right

MAXIMUM DOOR WIDTH

motor position:
LEFT
RIGHT

1,0m

motor position:
MIDDLE

1,2m

1,4m

1,6m

1,8m

2,0m

*Company OLEFINI reserves the right to alter given product specifications without further notice.

SIMPLE INDUSTRIAL

(door height up to 6,0 m)

motor
position:
LEFT
RIGHT

1,0m

1,2m

motor
position:
MIDDLE

1,2m

1,6m

2,0m

MAXIMUM DOOR WIDTH

- Energy Saving
- Barrier to Insects, Dust Odours, Pollutants & Humidity
- Controlled Microclimate
- Slim Line Design
- Easy Installation
- Conventional or Infrared Remote Control

air curtains with motor side left or right



Infrared
Remote
Control



Remote
Control

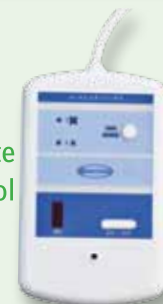

OPERATION WAYS

- ON-OFF / HI-LOW with wired remote control (C.B)
- ON-OFF / HI-LOW with infrared remote control (I.R)
- ON-OFF / HI-LOW with wired + infrared remote control (R.C)
- New eco control system (ECO) (consult supplier for availability)
- New logic control system (NL)

FOR USE IN:

LARGE INDUSTRIAL SPACES, DOORS & PASS THROUGH OPENINGS,
AIRPORTS, BUSS STATIONS, STORAGE AREAS, LARGE COLD STORAGE PLANTS,
GARAGES, STADIUMS



cross flow fan
Ø 133 diameter



OPTIONAL

- Filter
- Vertical mount
- Door switch
- Inox body
(430 stainless steel)
- Inox louver
(430 stainless steel)



TECHNICAL DETAILS

TYPE	L or R-22	L or R-23	K24	K-26	K-28	
Max door width (m)	1.0	1.2	1.2	1.6	2.0	
Max door height (m)	6.0	6.0	6.0	6.0	6.0	
Max Outlet velocity (m/sec)	14.0 / 12.0	14.0 / 12.0	14.0 / 12.0	14.0 / 12.0	14.0 / 12.0	
Max Air volume (m³/h)	3050 / 2615	3715 / 3185	3035 / 2600	4245 / 3640	5580 / 5280	
Motor power input (W)	660	660	660	660	660	
Capacitor (µF)	12	12	12	12	15	
Noise level in 1 m [dB(A)]	68 / 65	68 / 65	68 / 65	68 / 65	68 / 65	
DIMENSIONS	L: Total length (mm)	1270	1491	1259	1663	2097
	W: Total width (mm)	231	231	231	231	231
	H: Height (mm)	227	227	227	227	227
	l: Outlet length (mm)	1015	1236	1200	1603	2044
	w: Outlet width (mm)	76	76	76	76	76
	h: Outlet height (mm)	64	64	64	64	64
Weight (kg)	24	27	27	31	36	
Power supply (V/Hz/N-)	230 / 50 / 1	230 / 50 / 1	230 / 50 / 1	230 / 50 / 1	230 / 50 / 1	
Motor speed (rpm)	1370 / 1100	1370 / 1100	1370 / 1100	1370 / 1100	1370 / 1100	
Ingress Protection	IP20	IP20	IP20	IP20	IP20	

*Company OLEFINI reserves the right to alter given product specifications without further notice.

ELECTRICALLY HEATED INDUSTRIAL

(door height up to 5,0 m)



Infrared
Remote
Control

Remote
Control

OPTIONAL

- Filter
- Vertical mount
- Door switch
- Room thermostat

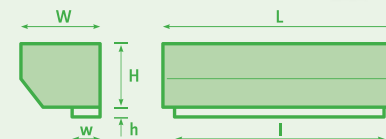

motor
position:
LEFT
RIGHT

1,0m

1,2m

1,8m

motor
position:
MIDDLE

1,2m

1,6m

2,0m

MAXIMUM DOOR WIDTH

- Energy Saving
- Barrier to Insects, Dust Odours, Pollutants & Humidity
- Slim Line Design
- Easy Installation
- 15 or 18 kW heating load (depending on models size)
- Motor position: Center, Left, Right

TECHNICAL DETAILS

TYPE	L or REH-22	L or REH-23	L or REH-27	KEH-24	KEH-26	KEH-28	
Max door width (m)	1.0	1.2	1.8	1.2	1.6	2.0	
Max door height (m)	5	5	5	5	5	5	
Max Outlet velocity (m/sec)	13.0 / 11.0	13.0 / 11.0	13.0 / 11.0	13.0 / 11.0	13.0 / 11.0	13.0 / 11.0	
Max Air volume (m³/h)	2830 / 2400	3450 / 2920	5050 / 4285	2815 / 2380	3940 / 3335	5180 / 4385	
Motor power input (W)	660	660	660	660	660	660	
Capacitor (µF)	12	12	15	12	12	12	
Noise level in 1 m [dB(A)]	67 / 64	67 / 64	67 / 64	67 / 64	67 / 64	67 / 64	
DIMENSIONS	L: Total length (mm)	1270	1491	2090	1259	1663	2097
	W: Total width (mm)	306	306	306	306	306	306
	H: Height (mm)	227	227	227	227	227	227
	I: Outlet length (mm)	1015	1236	1803	1200	1603	2044
	w: Outlet width (mm)	76	76	76	76	76	76
	h: Outlet height (mm)	64	64	64	64	64	64
Weight (kg)	36	40	52	40	45	51	
Thermal power (kW)	15 / 18	15 / 18	15 / 18	15 / 18	15 / 18	18	
Max current cons. (A) (per phase)	22 / 26	22 / 26	22 / 26	22 / 26	22 / 26	26	
T outlet - T inlet (°C)	17-18 / 19-20	17-18 / 19-20	17-18 / 19-20	17 / 18	17-18 / 19-20	19-20	
Power supply (V/Hz/N-)	400 / 50 / 3	400 / 50 / 3	400 / 50 / 3	400 / 50 / 3	400 / 50 / 3	400 / 50 / 3	
Motor speed (rpm)	1380 / 1150	1380 / 1150	1380 / 1150	1380 / 1150	1380 / 1150	1380 / 1150	
Heating stages	4	4	4	4	4	4	
Ingress Protection	IP20	IP20	IP20	IP20	IP20	IP20	

HOT WATER HEATED INDUSTRIAL

(door height up to 5,0 m)

3/4" water supply connection



heat exchanger



- Energy Saving
- Barrier to Insects, Dust Odours, Pollutants & Humidity
- Slim Line Design
- Easy Installation
- Low Noise Level
- Water valve connections
- 3/4" water supply connection
- Motor position: Center, Left, Right

OPTIONAL

- Filter
- Vertical mount
- Door switch
- Inox body (430 stainless steel)

TECHNICAL DETAILS

TYPE	L or RWH-22	L or RWH-23	KWH-24	KWH-26	KWH-28	
Max door width (m)	1.0	1.2	1.2	1.6	2.0	
Max door height (m)	5.0	5.0	5.0	5.0	5.0	
Max Outlet velocity (m/sec)	11.0 / 8.5	11.0 / 8.5	11.0 / 8.5	11.0 / 8.5	11.0 / 8.5	
Max Air volume (m3/h)	2425 / 1870	2935 / 2270	2390 / 1845	3350 / 2570	4395 / 3395	
Motor power input (W)	660	660	660	660	660	
Capacitor (μF)	12	12	12	12	12	
Capacity (lt)	1.0	1.28	0.96	1.4	1.88	
Noise level in 1 m [dB(A)]	64 / 60	64 / 60	67 / 64	67 / 64	67 / 64	
DIMENSIONS	L: Total length (mm)	1270	1491	1259	1663	2097
	W: Total width (mm)	306	306	306	306	306
	H: Height (mm)	227	227	227	227	227
	l: Outlet length (mm)	1015	1236	1200	1603	2044
	w: Outlet width (mm)	76	76	76	76	76
	h: Outlet height (mm)	64	64	64	64	64
	Weight without water (kgr)	31	34	32	37	48
*Air Inlet Temperature +15°C						

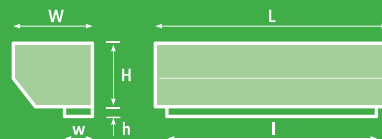

MAXIMUM DOOR WIDTH

motor position:
LEFT
RIGHT

1,0m

1,2m

motor position:
MIDDLE

1,2m

1,6m

2,0m

*Company OLEFINI reserves the right to alter given product specifications without further notice.

CONVENTIONAL OPERATION WAY



"OLEFINI S.A." Air Curtains can be controlled either by switches on the control panel located on the device, or by the wired-infrared remote control provided (if ordered).

* Air Curtains without Heat (simple ones) have switches on the control panel:

ON-OFF and HI-LOW which allow controlling both activation of the device and speed mode of the fan accordingly.

* Heated Air Curtain Models:

KEH43/44/46, MINI-700, MINI-800 S, R, LEH-13 S have a HI-LOW switch for regulating Motor speeds and a rotary switch for ON-OFF (motor operation) and Heaters regulation.

These Air Curtains work in the following way:

When switch is in ON position we start the fan, the Air Curtain works without Heat.

By rotating the switch further more you start Heaters operation according to the desired LOAD.

By positioning the switch to OFF you automatically close the motor and the Heaters as well.

"OLEFINI S.A." Air Curtains are supplied with thermostats located above the thermal elements to prevent their overheating. These sensors cut off power supply to the thermal elements at a temperature of $65^{\circ} \pm 5^{\circ} \text{C}$.

ATTENTION

*In case you have the above described situation for more than three times, you should switch off the device, and should consult a qualified electrician to find out the failure cause.

*If the device does not produce a sufficient warm air stream, it is necessary to apply to the service centre and locate the cause of the problem.

* To restore operation from a thermostat cut off in the device you should do the following:

1. Switch off the power supply to the Heaters,
2. Wait for 2-3 minutes to reset the thermostats,
3. Switch on again the power supply to the Heaters again,
4. Check the functionality of the device.

PSRF OPERATION.

"OLEFINI S.A." Heated Air Curtains (Electrical or water) have a wired-infrared remote control, allowing to switch ON-OFF the device, to change fan speed, to change heating level (HEAT POWER) or to control the hot water solenoid valve (WATER VALVE) depending on the way of heating.

To operate the Wired remote control you should first of all connect the cable to the CON BOX located on the back side of the Air Curtains.

To operate the hot water solenoid valve you should connect the valve cables to the terminal block (box) located on the back side of the Air Curtains.

It should be done according to the power supply electric scheme in the given instruction.

FUNCTIONS

1. ON-OFF: After pressing the button ON the Air Curtain starts operation.

After pressing the button OFF the Air Curtain stops if it worked without heating. If the Air Curtain was working in heating mode also, the fan will continue to rotate for approx. 120 seconds to cool the Air Curtain.

2. HEAT POWER or WATER VALVE: Control of the heat power (0% -33% -66% -100%) or opening/closing the solenoid water valve depending on the way of heating.

3. FAN SPEED: Control of the fan rotation speed. Though an Air Curtain has a three-stage motor, there are only two speeds (high and low) used in the existing models. The Middle speed (Blue wire) can be provided by a qualified electrician by switching terminals of the control unit.

INFRARED CONTROL UNIT (OPTIONAL)

"OLEFINI S.A." Air Curtains can be controlled by an additional infrared remote control unit.

You can switch on an Air Curtain by a remote control from distance of up to 10m and with an angle of deviation up to 15 degrees. CR 2032 type 3-V batteries are used for the remote control unit.

All "OLEFINI S.A." Heated Air Curtains, except models MINI 700, Mini 800S, INTELLECT 0.8, R, LEH-13 S, INTELLECT 1.0 and KEH-43/44/46 are supplied with a cable remote control. In case of cascade mounting of the Air Curtains their quantity should not exceed 5 units. Control of the Air Curtains is carried out by the wired remote control. A special telephone cable of 6x0.25 mm², is used to connect the Air Curtains between themselves. It's total length should not exceed 15 m.

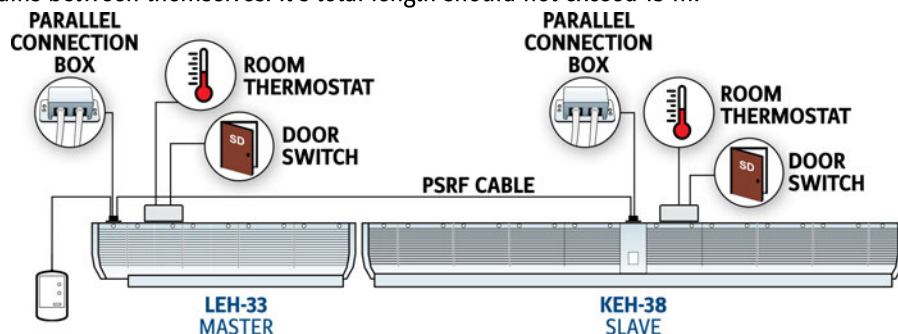

ATTENTION

*It is obligatory to control the Heated Air Curtains only by the wired remote control provided.

***It is forbidden to switch OFF the Air Curtain by the electric knife switch.**

*A special telephone cable should be used for cascade mounting of the Air Curtains, supplied ONLY by us.

*In case of Cascade unit connection each unit MUST have it's own Door Switch & Room Thermostat.

The new ECO System.

Maximum energy saving, ultimate comfort.

Olefini offers a new electronic control system for the entire line of Air Curtain products. The new system called 'ECO' is capable of further reducing the electricity bill by applying intelligent control on the unit's fan and heater elements. The operation of the unit is now smoother and more efficient.

The key features of the new line of products are:

Intelligent energy efficient "Auto" mode for electric heaters.

The air curtain will monitor the temperature outside the building and will constantly adjust its air flow speed and the power level of the electric heaters to ensure that power is not wasted when no needed.

Fine-tuned control for maximum environment comfort.

The intelligent control system try to maintain a good level of separation between the inside and outside of the building and at the same time, and whenever it is possible, the air flow is reduced to lower the noise level and offer more comfort.

Door switch with configurable time delays.

Olefini's air curtains are capable of altering their operation when the door is opened or closed. It is possible to set the air curtain to completely stop when the door is closed, or even have the air curtain work in a mode similar to space heater in the winter. All that with a touch of a button.

With Electric heaters or Hot water or Cold water.

Most of Olefini's air curtain models can be configured with electric heaters or with Hot/Cold water elements. Depending on the given project, an air curtain can operate with the building's chiller, boiler, heat pump, or just electricity when needed.

Wireless (IR) user panel and Wired panel with bright display.

The new ECO system comes with an improved and very easy to use wired panel. The user can adjust just the air curtain with a touch of a button or even leave the air curtain work completely automatically if necessary.

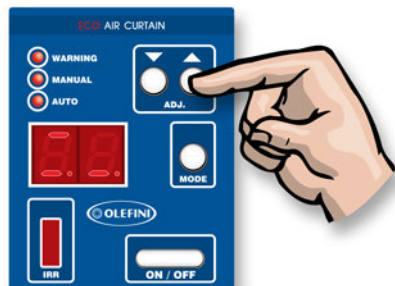

It is very intuitive and easy to use.

Two modes of operation are given.

An automatic mode where air flow and heater power level changes happens automatically, and a manual mode, where the user can adjust specific levels according to his/her preference.

Overheat alarm sensor, fan issue alarm sensor, and error codes to help periodic maintenance and cleaning.

Since our units are designed to offer their services at 24/7 for years, you can be assured that when the time comes to have the unit maintained, a fault indicator will guide the technician to the source of issue.

BMS networking supported, based on MODBUS (optional)

Olefini Air Curtains can now be connected to BMS systems. We have adopted the Modbus protocol for BMS connected air curtains. Each air curtain can be equipped with its own network card (supplied as an option) and it will present itself on a Modbus BMS network.

Over the network each air curtain can be under the complete control of the building's central control unit. And of course all the sensor values, fault status, alarms, status of operation, etc will be visible or adjustable remotely.

Master/Slave connection between multiple units on the same door.

Whenever there is a need to cover a very wide opening, Olefini's ECO air curtains can be cascaded with a very easy and cost efficient method. A simple cable is all that is needed to cascade one or more units together to work in a Master - Slave configuration. In this situation, only one control panel is needed and all connected air curtain can respond identically to the user's commands.

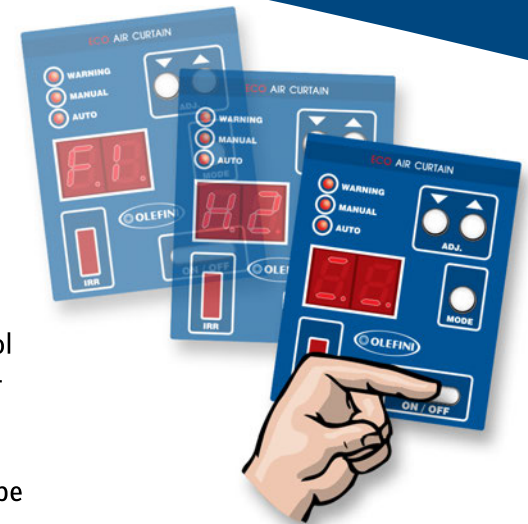
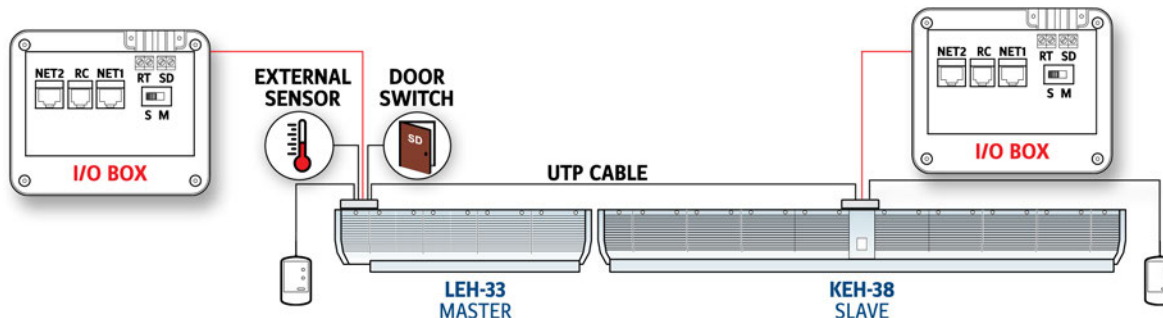

The UP-DOWN Air Curtain Systems.

Multi speed control

Olefini offers the Up-Down system for some models of Air Curtain products. The Up-Down system, is capable of adjusting the air curtain's fan speed and heater level according to the user's preferences.

The key features of the Up-Down line of products are:

Smooth fan speed control

The air curtain's fan speed can be controlled from the user panel and adjusted in small steps in order to provide maximum confort and low noise.

Door switch operation

If a door switch is connected the Up-Down is capable of stoping it's operation when the door is closed and the air curtain's help is not needed.

Wireless (IR) user panel

The Up-Down Air Curtains feature a build in user panel (on the unit) and a wireless remote control (IR). User can issue commands either from the build in panel, or the wireless remote control with a touch of a button. The air curtain provides indication of it's operating state with bright LEDs, and audible signals.



The INTELLECT Air Curtain Systems.

Innovation and advanced features.

Olefini offers the Intellect system for some models of Air Curtain products.

The Intellect system, is capable of adjusting the air curtain's fan speed and heater level according to the user's preferences. When the building's door is closed, the same air curtain can be used as a space heater, providing hot air during the winter.

The key features of the Intellect line of products are:

Smooth fan speed control

The air curtain's fan speed can be controlled from the user panel and adjusted in small steps in order to provide maximum comfort and low noise.

Operation Mode

Our new INTELLECT air curtains have the ability to work in two different Modes.

For being able each time to know in which mode the unit currently works we have to notice the colour of the ON-OFF led.

When LED is green: ***Air curtain mode***

When LED is red : ***Room Heater mode***

Door switch & Room thermostat

The Intellect is capable of altering it's operation when the door is opened or closed. When the door is open, the unit works as an Air Curtain. When the door is closed, you can have an intelligent space heater, which starts and stops with the help of an (optional) room thermostat.

With Electric heaters

Olefini's Intellect air curtains feature an electric heater which can be controlled in four different power levels (No heat, 33% heat, 66% heat or 100% heat full power).

Wireless (IR) user panel

The Intellect Air Curtains feature a build in user panel (on the unit) and a wireless remote control (IR). User can issue commands either from the build in panel, or the wireless remote control with a touch of a button. The air curtain provides indication of it's operating state with bright LEDs, and audible signals.



IP24 CONTROL SYSTEM

The IP24 Air Curtain Systems.

For demanding working environments.

Olefini offers the IP24 control system for a few selected models of Air Curtain products. The IP24 air curtains have an ingress protection of IP24 and can be used in places where there will be exposure to water and dust. Typical applications are car washing facilities, and outdoor installations.

The key features of the IP24 line of products are:

Constant fan speed

To avoid unnecessary system complexity, the IP24 system has only one speed for the fan.

With Electric heaters

Olefini's IP24 air curtains feature an electric heater which can be controlled in four different power levels (No heat, 33% heat, 66% heat or 100% heat full power). These heaters are of course IP24 certified and can work while they are sprayed with water or dust particles.

All their electric connections are completely sealed.

Industrial user panel with easily accesible buttons

The IP24 Air Curtains feature a wired user panel. The user can issue commands by pressing the large touch buttons. The buttons are carefully designed so that it is possible to operate them while wearing a glove (typical situation for given applications). The air curtain provides indication of it's operating state with bright LEDs, and audible signals.

NOTICE:

If needed we can also operate unit with an IR (IP20) remote control.

